

Alex^r. M^c. Dowell

Robert Chain

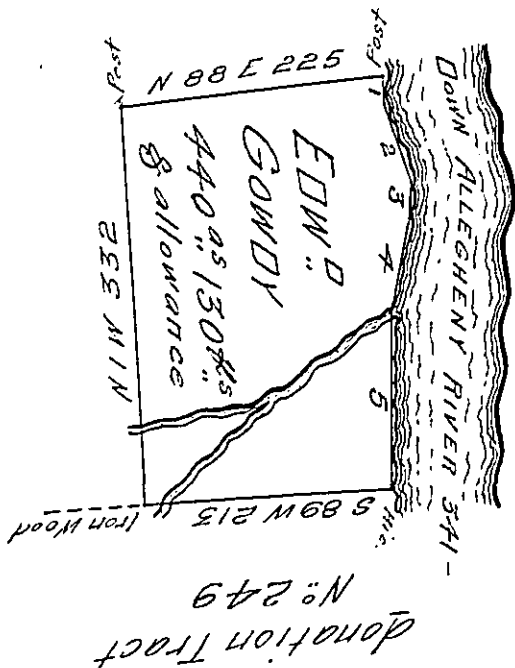

N ^o . Courses	Courses	Distance
1	South	24
2	S 15 E	62
3	South	32
4	S 15 W	86
5	South	137 1/2
		Total Dist: 341 1/2

In consequence of an Improvement Said to be Began May 11th 1795 There was Survey^d for Edward Gowdy the above Described Tract of Land Containing Four Hundred and forty Acres & 130 Parches with an allowance Proportioned to Six $\frac{1}{4}$ Cr Ct. Situate in District N^o. 5 in Allegheny County Survey^d December 1st 1795.

J John Moore D.S.

Daniel Brodhead Esq.
Surv^r. Gen^l. of Pennsylvania }

IN TESTIMONY that the above is a copy of the original remaining on file in the Department of Internal Affairs of Pennsylvania, made conformably to an Act of Assembly approved the 16th day of February, 1833, I have hereunto set my Hand and caused the Seal of said Department to be affixed at Harrisburg, this twenty-second day of August 1906

J. C. Brown
Secretary of Internal Affairs.